



## Evergreen Drive, West Drayton, Middlesex, UB7 9GH

- Drayton Garden Village
- Unfurnished
- Available NOW
- Four bedroom house
- Two parking bays
- EPC rating - B

**£2,200 PCM**

**Description**

Cameron present this large four bedroom family home located in the popular Drayton Garden Village development, situated close to Heathrow airport, West Drayton station and local amenities. The property boasts a modern kitchen with integrated appliances, downstairs W.C, reception/diner with patio doors leading to rear garden, four bedrooms (master accompanied with en suite shower) and main three piece suite bathroom. Available NOW and presented unfurnished.

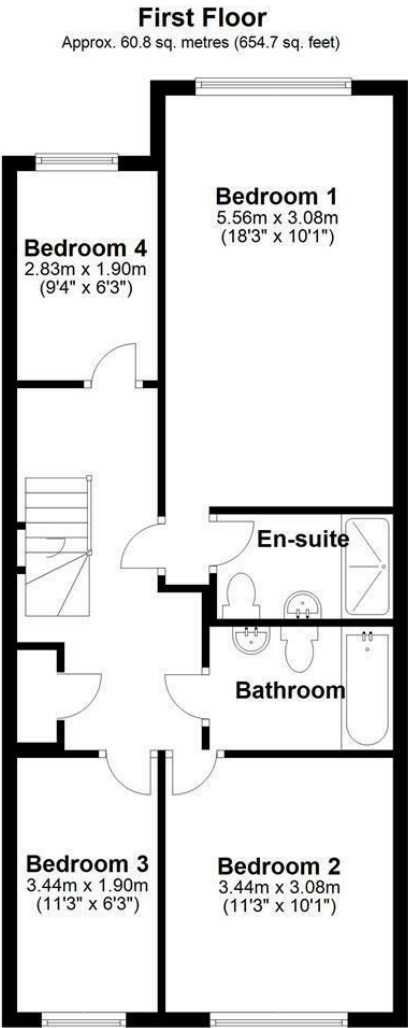
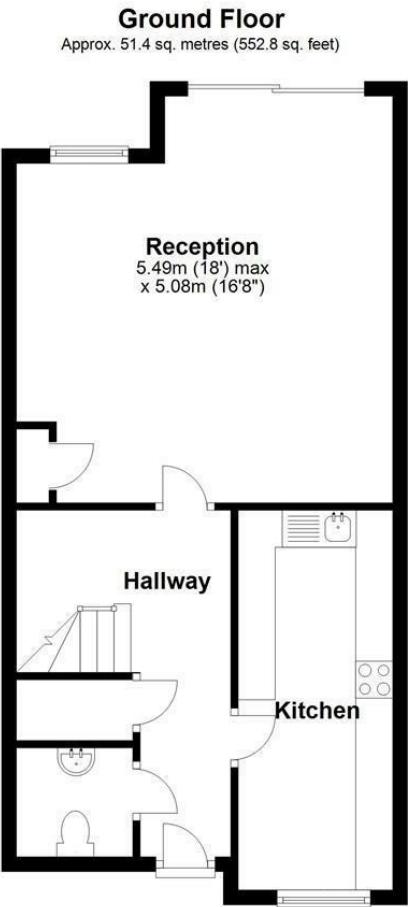

Total area: approx. 112.2 sq. metres (1207.5 sq. feet)

**IMPORTANT NOTICE**

These particulars have been prepared upon information supplied by the Vendor and should be verified by your surveyors and solicitors. We have prepared these sales particulars as a general guide to give a broad description of the property. They are not intended to constitute part of an offer or contract. We have not carried out a structural survey and the services, appliances and specific fittings have not been tested. All photographs, measurements, floor plans and distances referred to are given as a guide only and should not be relied upon for the purchase of carpets or any other fixtures or fittings. Lease details service charge and ground rent (where applicable) are given as a guide only and should be checked and confirmed by your solicitor prior to exchange of contracts